

MRC

Midwest Rail Conference



Conference Program



Midwest Rail Conference 2017

Midwest Connections: Passenger and
Freight Rail Look to the Future

August 15 - 17, 2017

WMU Fetzer Center, Kalamazoo, MI

Welcome



A Special Greeting from the Conference Co-Chairs

We would like to welcome everyone to the Midwest Rail Conference (MRC) in Kalamazoo, Michigan. This year's conference is the first time we are bringing several Midwest states together to discuss rail transportation. It's also the first time for us to join forces with the Summerail event organized by the Transportation Research Board (TRB) Freight Rail Committee (AR040) and with the annual meeting of the National University Rail Center (NURail). This conference brings together some of the brightest minds from rail stakeholder groups, and you can look forward to outstanding discussions and presentations!

With the large number of organizations involved, we are greatly in debt to the members of our three conference committees who have made sure everything is ready for the conference, from arranging the spaces, to registrations, to speakers and sponsors. A special thanks goes to Dave Nelson and his team from Michigan Tech for locking all the pieces into a cohesive conference, to the staff at the Fetzer Center, and to Forrest Van Schwartz and his team for organizing the field visits. We also need to thank our sponsors whose generous support allows us to keep the conference costs down, making it available to a wide range of stakeholders.

As conference co-chairs, we believe that our conference theme, *Midwest Connections: Passenger and Freight Rail Look to the Future*, captures the essence of the conference. Rail transportation does not stop at state lines, and regional collaboration is a necessity for successful rail operations. Our speakers today draw from experiences within and outside the region and we hope that you find the information and networking beneficial as you return to your daily activities in advancing rail transportation.

Welcome to the conference! — **Nikkie Johnson and Pasi Lautala**

Keynote Speaker: Joseph McHugh

Joseph McHugh is the vice president of State Supported Services – Business Development for Amtrak where he is responsible for managing the company's relationships with each of the 21 state partners and helping them grow their revenue and ridership. He has been with Amtrak for over two decades and, prior to his current position, served for 22 years in the Government Affairs group where he was responsible for initiating, developing, and communicating Amtrak's legislative and funding need to the U.S. Congress.



Tuesday's Activities

Student Scholarship Fundraiser Golf Outing
Committee Meetings

Opening Reception at Bell's Brewery
featuring the Norfolk Southern Lawmen
Band

See insert for details.



Midwest Rail Conference Technical Program | August 16th

7:15 – 8:00 AM		Breakfast & Registration		(Atrium/1035–1055)
7:45 – 8:00 AM		Welcome and Safety Briefing		(Kirsch)
Pasi Lautala Director, Rail Transportation Program, Michigan Technological University		Nikkie Johnson Project Manager–Economic Development & Freight Operations, Michigan Department of Transportation		
8:00 – 9:30 AM		Morning Plenary – Changes Facing the Rail Industry: Threats or Opportunities?		(Kirsch)
Moderator: Nick Little, Michigan State University				
Kirk Steudle Director, Michigan Department of Transportation “Future Mobility”		Deb Miller Member and former Chairman, Surface Transportation Board “Regulatory Reforms–Threat or Opportunity?”		Tim Strafford Associate General Counsel, Associati of American Railroads “Changes in the Rail Industry”
9:30 – 9:45 AM		Break		(Atrium)
9:45 – 10:45 AM		Plenary Panel – State DOT Rail Programs Overview		(Kirsch)
Moderator: Tim Hoeffner, Michigan Department of Transportation				
Matt Dietrich Executive Director, Ohio Rail Development Commission		Katie England Director–Multimodal Planning & Programs, Indiana Department of Transportation		Beth McCluskey Director–Office of Intermodal Project Implementation, Illinois Department of Transportation
				Dave Simon Chief of Railroads and Harbors, Wisconsin Department of Transportation
10:45 – 11:00 AM		Break		(Atrium)
11:00 AM – noon		Breakout Session #1A – Shipper Concerns		(Kirsch)
Moderator: Shasta Duffey, Lake State Railway				
Daniel Lynch Director–Centre for International Trade & Transportation, Dalhousie University “What EDs and Public Agencies should know about the movement of goods”		Gary Thompson Executive Vice President and COO, Regional Growth Partnership “Community Shipper Issues”		Carl Howard Director of Warehouse Operations, Lewis C Howard, Inc “Rail, Warehousing & Distribution”
11:00 AM – noon		Breakout Session #1B – High(er) Speed Rail		(Putney)
Moderator: Paul Vilter, Amtrak				
Beth McCluskey Director–Office of Intermodal Project Implementation, Illinois Department of Transportation “High(er) Speed Rail Corridor– Chicago/St. Louis”		Chen-Yu Lin Graduate Research Assistant, RailTEC, University of Illinois “Adjacent Track Accident Risk Analysis”		Bruce Nelson Sr. Principal Technical Specialist, WSP USA “Partnerships in Passenger Rail Stations –Planning, Design & Construction”
11:00 AM – noon		Breakout Session #1C – Property Risk and Management		(1040–1050)
Moderator: Jon Cool, Michigan Railroad Association				
Bob VanderClute President, Firstrail International “Tresspass Prevention through Education”		Chris Barkan Executive Director, RailTEC, University of Illinois “Risk Mitigation and Technologies for Rail Applications”		Colin Brooks Senior Research Scientist, Michigan Technological University “Drone Use Issues and Advantages”
Noon – 1:30 PM		Lunch and Keynote – What’s Ahead for Amtrak?		(1035–1055)

Midwest Rail Conference Technical Program | August 16th

1:30 – 2:30 PM

Breakout Session #2A – Future of Freight

(Kirsch)

Moderator: Pete Swan, Penn State

Brian Buchanan

Manager of Network Strategies, CN Railroad

“Satellite Intermodal Ramps”

Ryan Fischer

Assistant Vice President–Industrial Development, G&W Railroad

“Industrial Developments: A Shortline Perspective”

Tyler Dick

Senior Research Engineer and Director of Education, RailTEC, University of Illinois

“NURail–Schedule Flexibility and Performance”

1:30 – 2:30 PM

Breakout Session #2B – Urban Rail

(Putney)

Moderator: Libby Ogard, Prime Focus

Kevin Keller

Vice President & National Director of Rail Business Planning, HDR, Inc

“Developments in North American Passenger Rail and Transit Planning”

Paul Childs

Chief Operating Officer, QLINE Detroit

“A National Model for Public Private Partnership in Transit”

Barry Murray

Director of Economic and Community Development, City of Dearborn, MI

“Building a Multi-Modal Transportation Future”

1:30 – 2:30 PM

Breakout Session #2C – Grade Crossing Issues

(1040–1050)

Moderator: Tammy Wagner, Federal Rail Administration

John Sharkey

Vice President–Signal Systems, CTC, Inc

“Intersections near RR Grade Crossings”

Larry Bowron

Transportation Director, City of Battle Creek

“The Battle Creek Quiet Zone”

Reg Souleyrette

Department Chair of Civil Engineering, University of Kentucky

“Grade Crossing Research at NURail Universities”

2:30 – 2:45 AM

Break

(Atrium)

2:45 – 3:45 PM

Breakout Session #3A – Short Line Panel

(Kirsch)

Moderator: Matt Dietrich, Ohio Rail Development Commission

Stefan Loeb

Executive Vice President–Network Strategies, Watco Companies

“Short Line Panel”

Troy Strane

General Manager, Indiana Northeastern Railroad

“Shortline Operations Issues”

Sean Pengelly

Engineer–Projects & Development, Lake State Railway

“Economics & Planning of Short Haul/Short Line Intermodal Rail Service”

2:45 – 3:45 PM

Breakout Session #3B – Inter-City Services

(Putney)

Moderator: Kay Chase, Michigan Association of Railroad Passengers

Mike Franke

Senior Director–State Government Contracts, Amtrak

“Amtrak 2017 Update”

Martin Bloedt

Sales and Product Manager–Locomotives, North America, Siemens

“New Passenger Locomotives for the North American Market”

Anna Lynn Smith & Peter Schwartz

Transportation Consultant and Project Manager, WSP USA

“FRA’s Midwest Regional Rail Planning Study”

Senior Planner, Federal Railroad Administration

2:45 – 3:45 PM

Breakout Session #3C – Creating a Resilient Railroad

(1040–1050)

Moderator: Andreas Hoffrichter, Michigan State University

Joe Smak

Director of Engineering, Amtrak

“Creating and Maintaining a Resilient Railway”

Amanda Martin

Freight and Passenger Policy Coordinator, Iowa DOT

“Iowa Statewide Travel Analysis Model (iTRAM)–Rail Component”

Riley Edwards

Research Scientist and Senior Lecturer, RailTEC, University of Illinois

“NURail Research on Resilient Railway Infrastructure”

3:45 – 4:00 PM

Break

(Atrium)

4:00 – 4:30 PM

Networking and Student Poster Session

(Atrium)

4:30 – 5:00 PM

3-Minute Student Thesis Competition

(TBD)

5:00 – 7:00 PM

Closing Reception

(Atrium)

TRB Summerail Field Visits | August 17

7:30 AM – noon

Cargill Facility & Amtrak ride to Battle Creek

12:30 – 1:00 PM

Those not attending Little River return to Kalamazoo

12:30 – 5:30 PM

Lunch & Little River Steam Train Ride



Fetzer Center Wifi Code

55zimmerman

Tuesday Dress Code

All Events – Casual

Wednesday Dress Code

Conference – Business Casual

Thursday Dress Code

Field Trips – Casual (Close-toed shoes required)

ORGANIZERS



Rail Transportation Program

Michigan Tech Transportation Institute • Michigan Technological University



TRANSPORTATION
RESEARCH
BOARD



In Association With:



WMU Fetzer Center Parking and Facilities Information

WMU Fetzer Center:
2350 Business Court
Kalamazoo, MI 49008

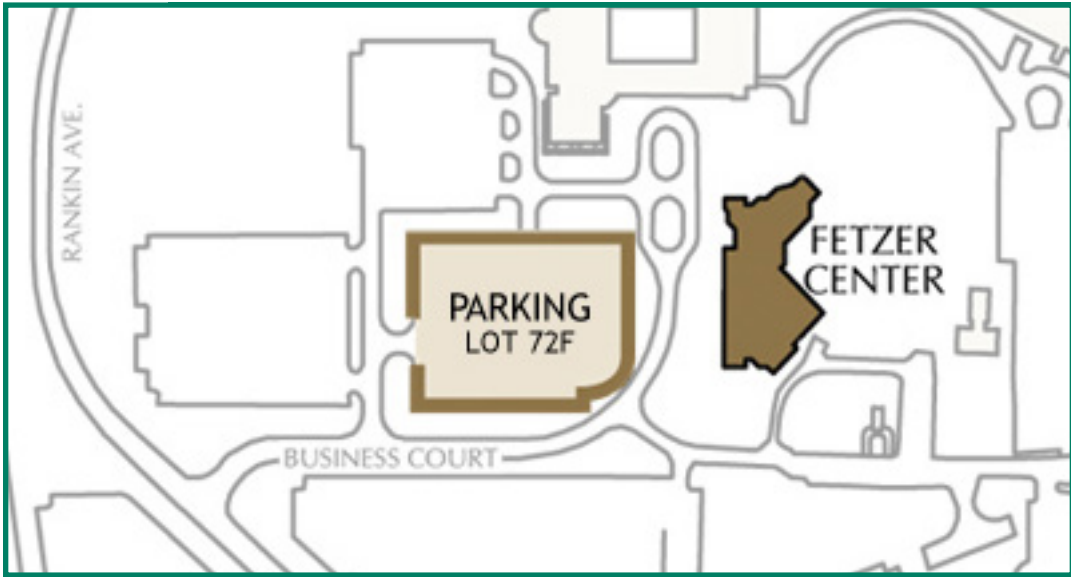
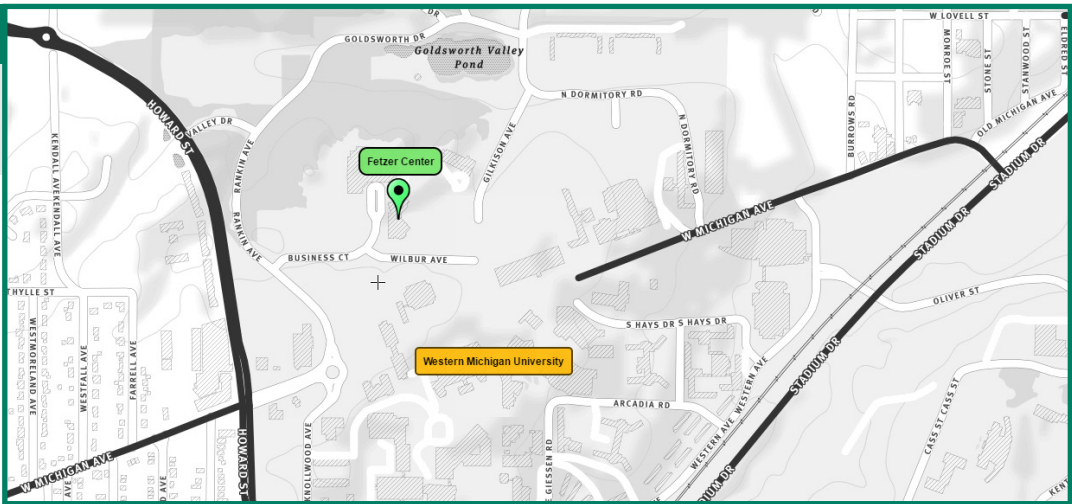

Fetzer Center Parking

Fetzer Center 1st Floor Layout

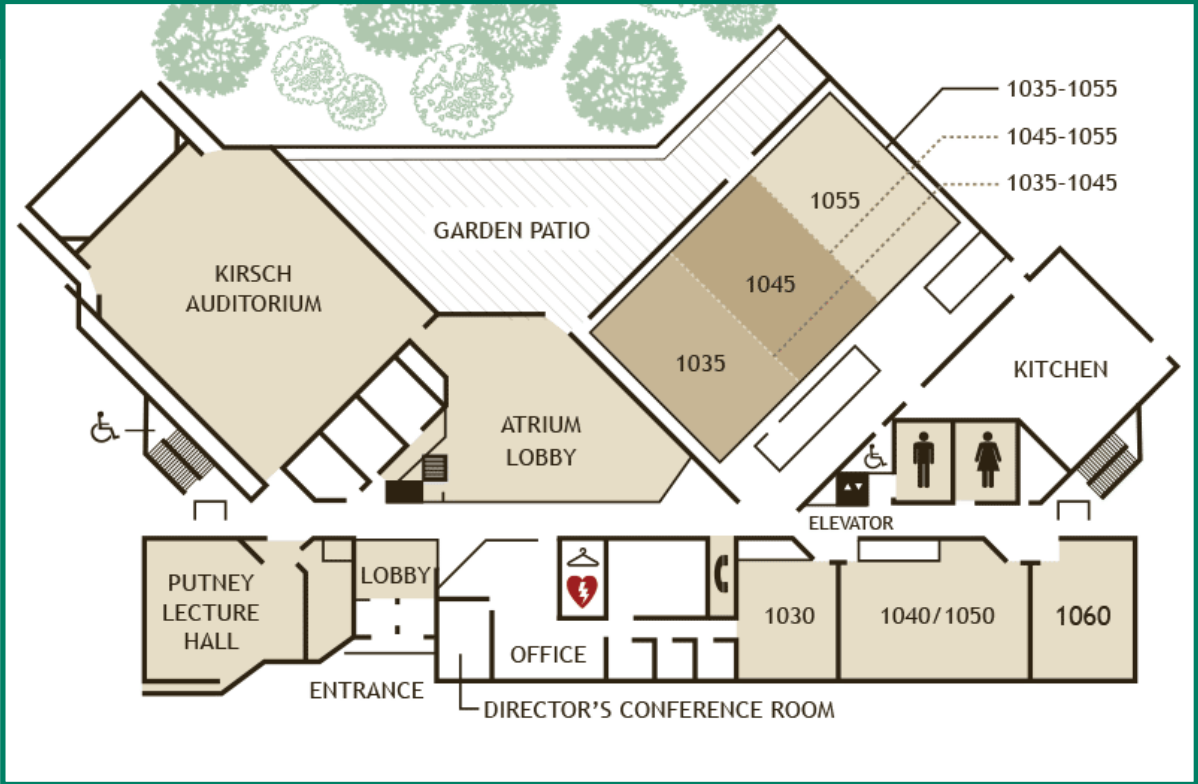

Diamond Sponsors



Platinum Sponsors



Gold Sponsors



Silver Sponsors



Conference Planning Committee

Tammy Wagner – FRA; Forrest Van Schwartz – Global Transportation Consultancy; Shasta Duffey – Lake State Railway; Kay Chase – Michigan Association of Railroad Passengers (MARP); Nikkie Johnson – Michigan DOT; Jon Cool – Michigan Railroads Association; Andreas Hoffrichter, Nick Little, and Sue Lonier – Michigan State University; Amanda Kerttu, Pasi Lautala, and David Nelson – Michigan Tech; Matt Dietrich – Ohio DOT; Peter Swan – Penn State; Libby Ogard – Prime Focus; Tyler Dick and L. B. Frye – University of Illinois; Laura McNichol – Watco Companies

Sponsored Events

Opening Reception Sponsor



Lunch Sponsors



Little River Steam Train Sponsor



Breakfast Sponsors



Refreshment Breaks Sponsors



LEWIS C. HOWARD, INC.
Industrial Warehousing Distribution Services
Transportation and Boxcar Services



Bags Sponsor



Flash Drives and USB Chargers Sponsor



Field Visits

Transportation Sponsors



Notepads Sponsor



Railway Research and Education
Eli Broad College of Business
MICHIGAN STATE UNIVERSITY

Lanyards Sponsor



Conference Cups Sponsor



Student Scholarship Sponsors

GW & PFS Mr. John H Guidinger

